

Y Filter

FIP



The FIP Y-Filter screens and collects solid particles from the water flow by means of a filter screen. The screen is easy to remove for maintenance.

CHARACTERISTICS

- ✓ Filtration from 300 to 900 micron
- ✓ Easy to clean
- ✓ Transparent or grey PVC housing

TECHNICAL DATA

Models	: RVUIT (double nut: adhesive insert, transparent) : RVUIV (double nut: adhesive insert, grey) : RVIT (adhesive insert, transparent) : RVIV (adhesive insert, grey)
Diameter	: 16 - 110 mm
Pressure class	: PN16
Max. pressure at 20°C	: PN16 (dia. 16 - 63 mm), PN10 (dia. 75 mm), PN6 (dia. 90 - 110 mm)
Dirt trap material	: PVC or transparent PVC (housing) : PVC (strainer) : EPDM (seal), optionally FPM
Connection	: bush with screw nut (dia. 16-63 mm), glue fitting (dia. 75 - 110 mm) PVC screen size : 1.5 mm ~ 500 micron (standard)
Sizes (optional)	: 1 mm ~ 300 micron : 2 mm ~ 600 micron : 2.5 mm ~ 900 micron : 0.7 mm ~ 370 micron (stainless steel strainer)

Kv-value (l/min)

Diameter (mm)	16	20	25	32	40	50	63	75	90	110
Kv-value	22	40	70	103	188	255	410	650	1050	1700

Parts list and drawing

No.	Description
1	Body
2	Screen
3	Bonnet
4	Screen support housing
5	O-Ring seal
6	Retaining ring

No.	Description
7	Lock nut
8	Split ring
9	Socket seal O-Ring
10	End connector
11	Union-nut

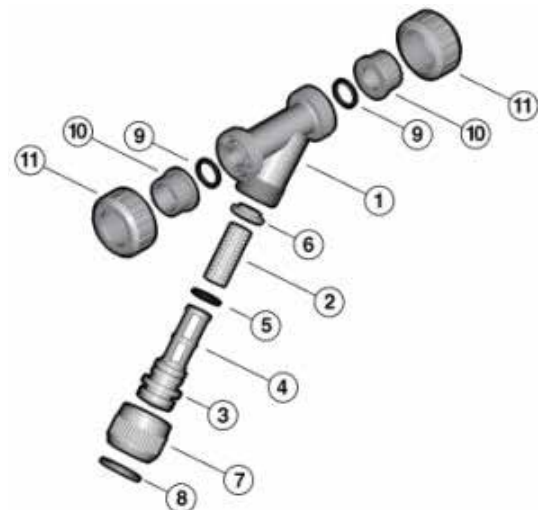

INSTALLATION & MAINTENANCE

- ✓ Install the dirt trap with the arrow in the direction of the liquid flow and the dirt trap facing downwards.